

28 April 2022

Mr Matthew Stewart  
The General Manager  
City of Canterbury Bankstown Council  
PO Box 8  
Bankstown NSW 1885

**Email:** [council@cbc.city.nsw.gov.au](mailto:council@cbc.city.nsw.gov.au)

## **Plan of Management – TOMRA Container Recycling Facility – 82 Yerrick Road, Lakemba**

This Plan of Management (PoM) has been prepared by TOMRA Collection Pty Ltd (TOMRA) in relation to the approved TOMRA Container Recycling Facility at 82 Yerrick Road, Lakemba (Lot 4 on DP 6727).

### **Purpose**

As a key provider of recycling services to the communities in which we operate, TOMRA is dedicated to the implementation of practices that result in sustainable environmental outcomes for all aspects of our business.

This PoM supports our commitment to minimising the impact of our operations on pollution, waste, recycling and sustainability issues, and conducting all matters of business in an environmentally sound manner.

This PoM outlines TOMRA's management policies which address protocols for the operation of the approved TOMRA Container Recycling Facility, the subject of a Development Application with the City of Canterbury-Bankstown Council for an Extension of Trading Hours.

The TOMRA Container Recycling Facility at 82 Yerrick Road, Lakemba operates as a Reverse Vending Centre which provides a front-of-house area that is open to the general public during set hours of operation to deposit containers for refund under the NSW Return and Earn litter reduction initiative introduced by the NSW State Government on 1 December 2017.

The Return and Earn container deposit scheme offers a 10c refund to consumers for depositing eligible drink containers at return points across NSW (including 82 Yerrick Road, Lakemba).

TOMRA is committed to public safety at all times. The public do not need to come into contact with any staff at the centres and Touch-Free Recycling reduces the number of touchpoints when returning your containers.

### **Objectives of the Plan of Management**

The objectives of the PoM are as follows:

- Provide an easy to follow document that outlines how the TOMRA Container Recycling Facility at 82 Yerrick Road, Lakemba will be managed and maintained.
- To ensure that management policies and procedures support the successful operation of the TOMRA Container Recycling Facility as a responsible and responsive member of the local community.
- Ensure that all servicing of the TOMRA Container Recycling Facility is carried out in a coordinated, safe and managed manner, with minimal disruption to the surrounding area.
- Ensure that vehicle access and traffic generation associated with the TOMRA Container Recycling Facility has a minimal impact on the local road and parking network.
- Minimise the impacts of the operation of the premises on school users and the wider community and to respond to community concerns promptly and professionally.

### Site Location and Context

The site is identified as 82 Yerrick Road, Lakemba and is legally described as Lot 4 on DP 6727.

**Figure 1** provides an aerial photograph of the site and overall locality. A site plan is included in **Figure 4** below.



**Figure 1 - Site Aerial**

*Source: Nearmap, 2022*

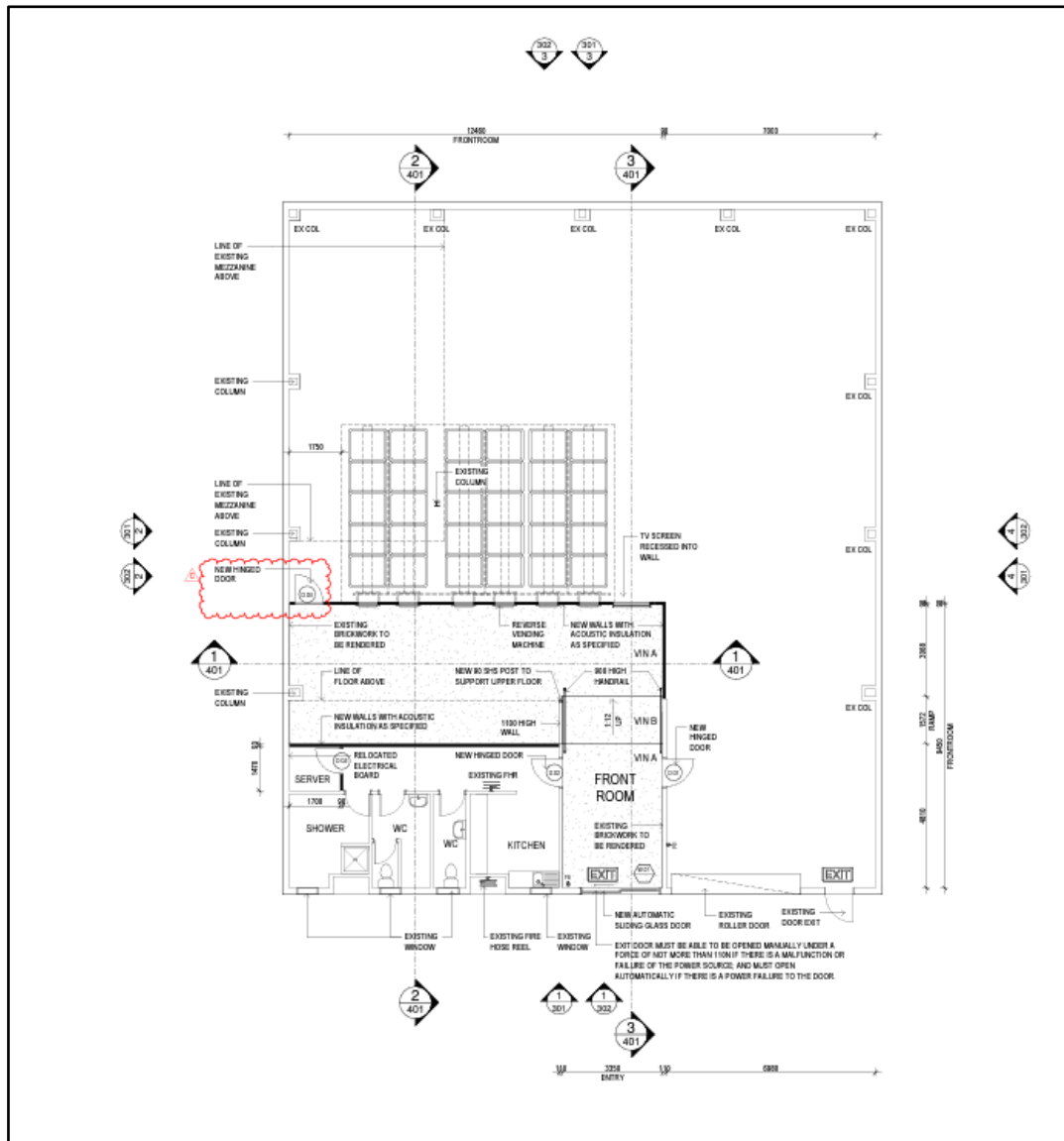

**Figure 2 – Approved Ground Floor Plan**

Source: Idea Architecture, 2022

## Operational Management Plan

Consent to Development (No. 5460-1991) was granted on 14 June 1991 for a Warehouse..

An additional Building Application (BA-557/1991) was approved 22 August 1991 for a Factory.

As such, a Complying Development Certificate (CD-1099/2021) was issued by a Private Certifier for “Internal alterations and fit out to existing commercial tenancy” at 82 Yerrick Road, Lakemba NSW 2145 (Lot 4, DP 6727) as a Container Recycling Facility (Internal Alteration to Existing Commercial Premises - Container Recycling Facility) on 4 November 2021.

## **Hours of Operation**

The following hours of operation are proposed:

- Monday to Saturday: 7.00am to 7.00pm.
- Sunday and Public Holidays: 8.00am to 6.00pm.

## **General Amenity**

At all times, TOMRA shall consider the amenity of its neighbours and shall take all reasonable measures to ensure that any adverse impacts on the amenity of the surrounding area are mitigated.

The Container Recycling Facility shall be operated in such a manner as not to adversely interfere with, or materially affect the operation of nearby businesses and/or residents as demonstrated with the Noise Impact Assessment prepared by Reef Acoustics in support of the DA for a Change in Hours of Operation.

## **Security**

The security and safety of the general public are to be of top priority to the TOMRA.

The Container Recycling Facility will have CCTV surveillance cameras in the premises in strategic places including the building entry points and common areas. This system has automated recording technology, longer video storage capacity and video motion detection.

All cameras will operate 24 hours a day. The surveillance tapes / videos are to be kept for at least 1 month for viewing by the Police if required.

The quality of the images filmed are to satisfy Police requirements.

TOMRA will ensure the system is maintained and in good working order. TOMRA will ensure that the coverage is operated with due regards to the privacy and civil liberties of all persons within the development and in strict accordance with the Privacy and Personal/Information Protection Act 1998.

TOMRA is committed to the installation of an emergency call speaker within the facility whereby if an individual feels threatened or if there is an issue on site, they will be directed to the TOMRA Cleanaway Hotline call centre assistance.

## **Lighting**

External sensor lighting will be provided around the building and building entries to enable clear vision and will be designed in such a manner so as to prevent concealment and shadowing. The standard of lighting will not only reduce the fear of crime in accordance with Australian lighting standards, but also serves to provide clear identification of activity using the high technology CCTV cameras proposed.

## **Access and Car Parking**

The proposal is limited to a change in hours of operation to allow for the approved TOMRA Container Recycling Facility to operated on Sundays and Public Holidays between 9.00am and 6.00pm.

Customer access and car parking is provided via Yerrick Road. Six (6) dedicated on-site car parking spaces are provided between the TOMRA Container Recycling Facility to meet the demand for customers visiting the site.

## Noise

The TOMRA Container Recycling Facility will be managed to minimise the potential of causing a nuisance, or an offensive noise as defined in the *Protection of the Environment Operations Act 1997* to adjoining properties or the public.

The TOMRA Container Recycling Facility operates as a Reverse Vending Centre and as such the drop off location is fully contained to minimise the potential for noise generation.

The premises will be operated in accordance with noise conditions imposed by local authority as part of any development approval as well as any requirements of the relevant authority.

This operation has been endorsed by Reef Acoustics in their Noise Impact Assessment prepared in support of the DA for a Change in Hours of Operation.

## Loading / Unloading

TOMRA will endeavour to ensure that the loading and unloading of containers to be removed from the site are to be made between 7am and 7pm outside of sensitive hours.

## Incident Reporting

The TOMRA Cleanaway Hotline is your one-stop destination for all of your support needs for the NSW Return and Earn scheme.

If you need assistance, are reporting feedback or have a general question. our customer service team is ready to take your call on 1800 290 691.

All environmental incidents can be reported to TOMRA verbally or via email at [ENQUIRIES@TCNSW.COM.AU](mailto:ENQUIRIES@TCNSW.COM.AU)

Further, TOMRA Collections Solutions postal address is identified below:

Unit 2, 39 Herbert Street  
St Leonards  
NSW 2065  
Australia

## Complaints and Contacts

### Internal

- TOMRA Help Desk – 1800 290 691
- Site Supervisor – 0404 677 076
- Operations Manager – 0439 607 443

### External

- Canterbury-Bankstown Council – 02 9707 9000
- NSW Environment Protection Authority (EPA) – 131 555
- Auburn Police Area Command – 02 9646 8699